

## Encoder WDG 40S



- Robust and economical encoder with small dimensions
  - Screw flange
  - With control output
  - Easy screw mounting
  - Protection to IP67, shaft sealed to IP65
- [www.wachendorff.de/wdg40s-engl](http://www.wachendorff.de/wdg40s-engl)

### Application field

Machines used in the wood and plastic industries, car wash systems, food processing machines, elevators, machine construction, doors and gates, wood processing machines, textile machines, motion control.

**Available PPR** up to 2500

### Mechanical Data

#### Housing

- Screw flange: Aluminium incl. nut M20 x 1,5
- Housing: Aluminium, powder coated

#### Shaft

- Material: stainless steel
- Load on shaft end: max. 80 N radial  
max. 50 N axial
- Starting torque: approx. 0,2 Ncm at ambient temperature

#### Bearings

- Type: 2 precision ball bearings
- Service life: 10<sup>9</sup> revs. at 100% of full rated shaft load  
10<sup>10</sup> revs. at 40%  
10<sup>11</sup> revs. at 20%

Operating speed: 12.000 rpm

Weight: approx. 90 g

Connections: shielded cable or connector

Starting torque: max. 10 Nm

Protection rating: IP67, shaft sealed to IP65  
(EN 60529)

Operating temperature: -20... +80 °C

Storage temperature: -30... +80 °C

### Electrical Data

Power supply	Output circuit	Key	Output circuit*	Key
10-30 VDC	HTL	G24	HTL, inv.	I24
5 VDC	TTL	G05	RS422, TTL comp.	I05

\*Only for cable or connector: K2, L2, SB8, SB12

### Cable connection K2

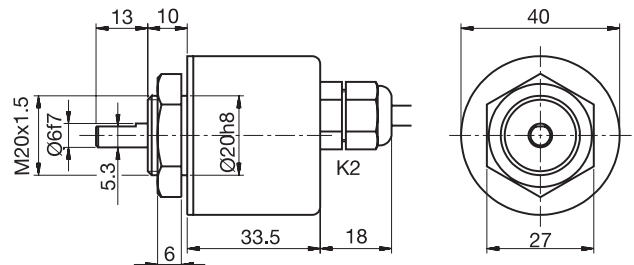

### Cable connection K1

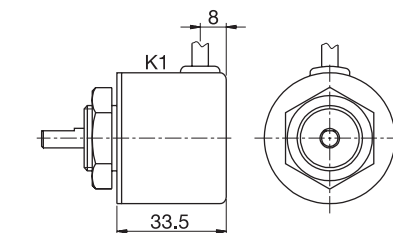

K1: radial

### Connector S2, 7-pin

