

Construction and Dimensions

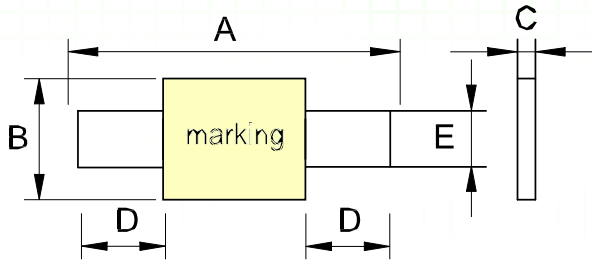

Style1

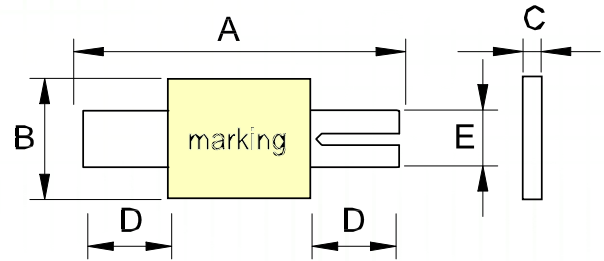

Style2

Unit:mm

Model	A		BC		D		E		Style		
	Min.	Max.	Min.	Max.	Min.	Max.	Min.	Max.			
SVT170	14.0	17.5	6.5	7.4	0.5	1.1	3.7	5.7	3.8	4.2	1
SVT175	20.5	23.1	3.3	3.9	0.5	1.1	4.0	6.0	2.3	2.7	1
SVT200	20.5	23.1	3.3	3.9	0.5	1.1	4.0	6.0	2.3	2.7	1
SVT210	20.5	23.1	4.8	5.3	0.5	1.1	4.0	6.0	3.8	4.2	1
SVT210S	20.5	23.1	4.8	5.3	0.5	1.1	4.0	6.0	3.8	4.2	2
SVT240	23.5	26.2	4.8	5.3	0.5	1.1	4.0	6.5	3.8	4.2	1

* Slit size : 0.5mm x 4.0mm (Nominal)

Electrical Characteristics at 23°C :

Model	V _{max} (Volts)	I _{max} (Amps)	I _{hold} (Amps)	I _{trip} (Amps)	R _{min} (Ω)	R _{max} (Ω)	R _{l max} (Ω)	P _(d) (Watts)
SVT170	16	100	1.70	3.40	0.030	0.052	0.12	1.2
SVT175	16	100	1.75	3.60	0.030	0.052	0.12	1.2
SVT200	16	100	2.00	4.80	0.023	0.039	0.09	1.2
SVT210	16	100	2.10	4.80	0.018	0.035	0.08	1.2
SVT210S	16	100	2.10	4.80	0.018	0.035	0.08	1.2
SVT240	16	100	2.40	5.90	0.013	0.030	0.07	1.2

*

Typical Time to Trip Curves at 23°C :

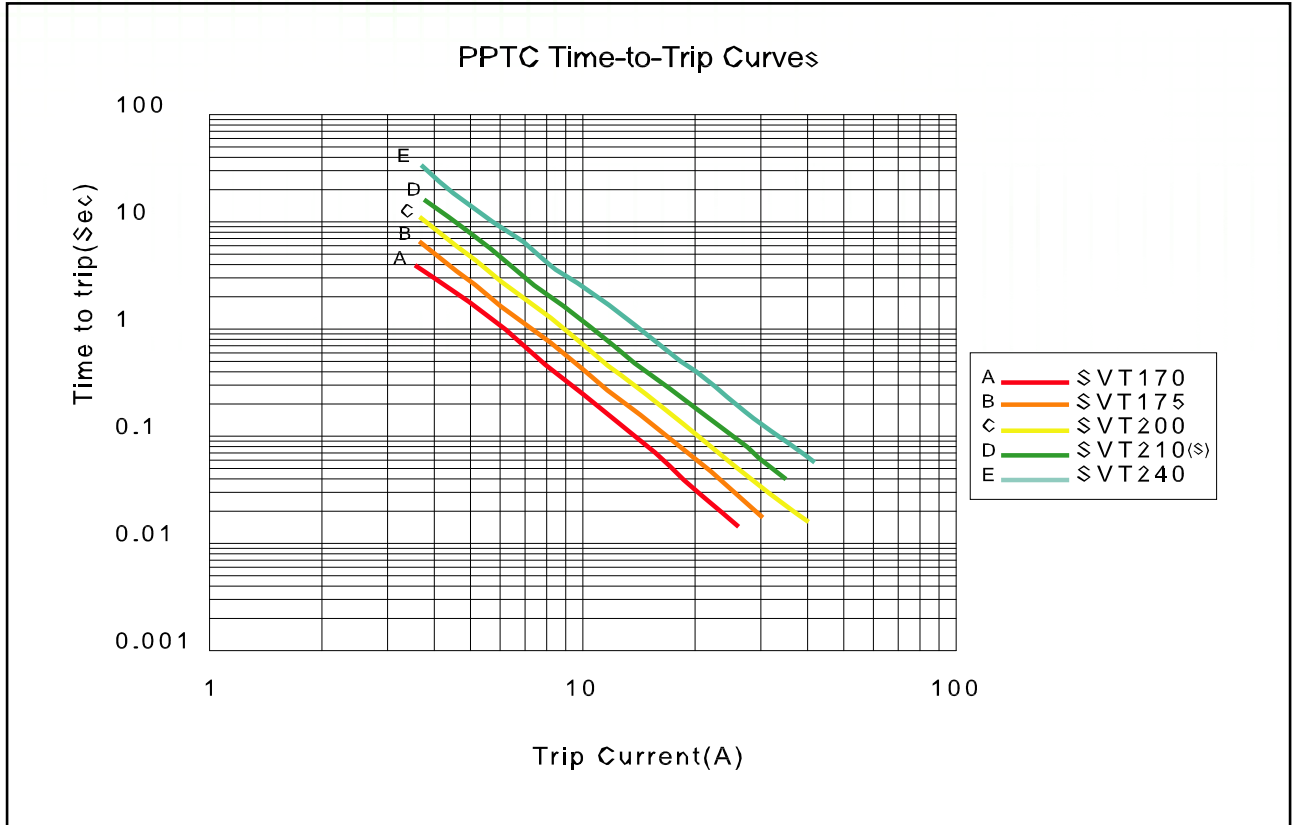

Thermal Derating Chart

Unit:Amps

TEMP(°C)	-40	-20	0	23	40	50	60	70	85
SVT170	2.95	2.62	2.27	1.70	1.24	1.00	0.75	0.50	0.17
SVT175	3.05	2.71	2.33	1.75	1.31	1.05	0.79	0.52	0.18
SVT200	3.45	3.05	2.65	2.00	1.46	1.17	0.87	0.58	0.20
SVT210(S)	3.63	3.23	2.75	2.10	1.53	1.24	0.93	0.60	0.21
SVT240	4.15	3.65	3.15	2.40	1.75	1.40	1.03	0.70	0.24