

JIN ZON MC-Series Magnetic Door Contacts

MC-31

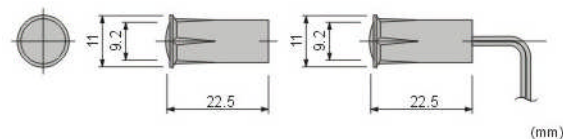

- 22.5 mm length short body of MC-21
- Available in close loop, open loop and SPDT



MC-31 Series
MC-31 XX

MC-41



- 3/8" Diameter - press fit
- Recessed "shortie" switch set, ideal to thin framed doors and windows
- Available in close loop

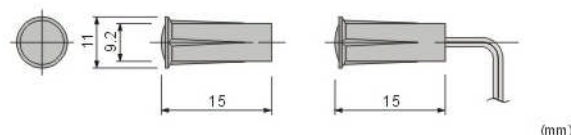

MC-41 Series
MC-41 XX

MC-66



- Screw driverless terminals, wire connection needs no tools
- No splicing required
- Accepts stranded wire #24AWG-18AWG
- Available in close loop

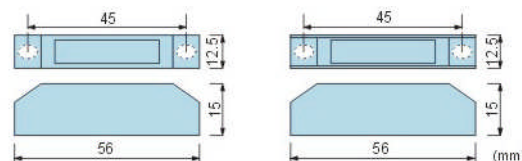

MC-66 Series
MC-66 XX

MC-69



- Regular gap up to 25mm
- Spacers upon request
- Extra wide gap up to 35mm available upon request
- Available in close loop

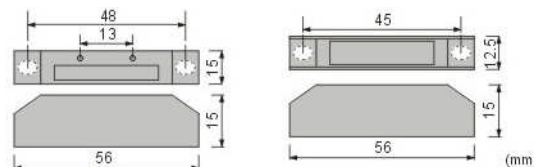

MC-69 Series
MC-69 XX

MC-73



- Regular gap up to 25mm
- L terminals insure a quick and trouble free connection
- Surface mount / screw terminals
- Available in close loop

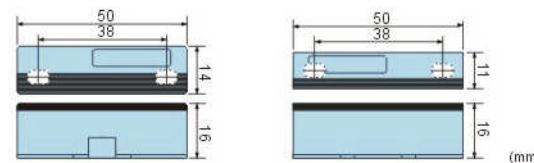

MC-73 Series
MC-73 XX