

# NS-V Series Inclinometer

Single or Dual Axis Inclinometer  
Measurement Range  
 $\pm 5^\circ$  up to  $\pm 45^\circ$   
Voltage or Current Output Signal

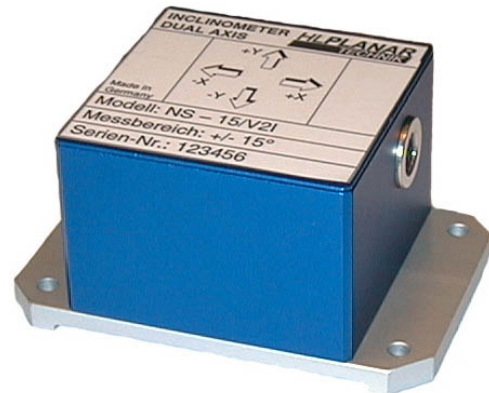

The **V-Series** of conductive single or dual axis inclinometers offers a modern electronic in an environmentally protected and robust aluminium anodizing housing. This fully calibrated inclinometer is available with an analogue voltage output signals or current output signal. They have a compact study design and show large range of applications are possible.

## FEATURES

- Robust AL-Housing
- High Resolution
- Protection Class IP 65
- Rugged 7 Pins Male M8 Connector
- Easy to Mounted

## APPLICATIONS

- Mobile and Stationary Cranes
- Building Control
- Road Construction Machines
- Weighing Systems
- Platform Leveling

## dimensions [mm]

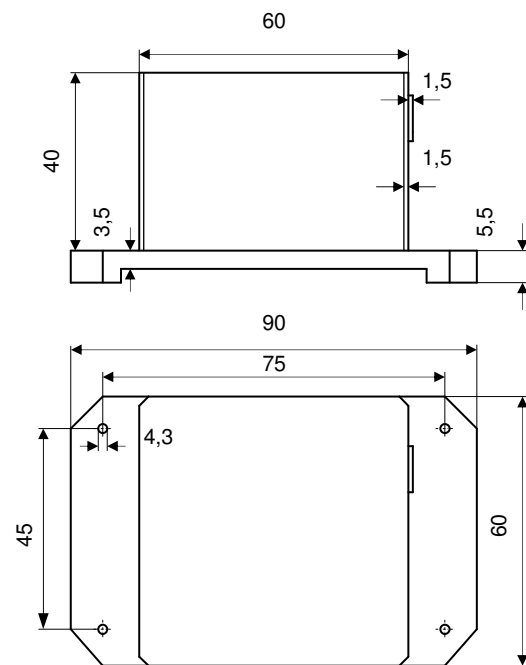

# NS-V Series Inclinometer

## performance specifications

### PARAMETERS

	Conditions	Min	Type	Max	Unit
Measurement range		-5(-45)		+5(+45)	°
Resolution		0.001		0.01	°
Accuracy	0°C ...+70°C	0.1		0.5	°
Zero point temperature stability	0°C ...+50°C		0.1		°
Sensitivity temperatur stability	0°C ...+50°C		0.3		°
Analogue voltage output signal (1)	Ratiometric	-2		+2	V
Analogue current output signal (2)		4		20	mA
Current consumption		9		30	mA
Power supply		12		24	VDC
Operating temperature range		0		+70	°C
Storage temperature range		-40		+85	°C
Weight		300		320	g
Dimensions	W x D x H		90 x 60 x 45.5		mm

(1) for NS-xx/V,NS-xx/V2 version

(2) for NS-xx/VI,NS-xx/V2I version

The information in this sheet has been carefully reviewed and is believed to be accurate; however, no responsibility is assumed for inaccuracies. Furthermore, this information does not convey to the purchaser of such devices any license under the patent rights to the manufacturer. Measurement Specialties, Inc. reserves the right to make changes without further notice to any product herein. Measurement Specialties, Inc. makes no warranty, representation or guarantee regarding the suitability of its product for any particular purpose, nor does Measurement Specialties, Inc. assume any liability arising out of the application or use of any product or circuit and specifically disclaims any and all liability, including without limitation consequential or incidental damages. Typical parameters can and do vary in different applications. All operating parameters must be validated for each customer application by customer's technical experts. Measurement Specialties, Inc. does not convey any license under its patent rights nor the rights of others.

## ordering info

PART NUMBERING	UNIT	SHORT DESCRIPTION
G-NSV2-001	NS- 5/V2	dual axis,range +/- 5°,Vcc 12...24VDC,output V
G-NSV2I-001	NS- 5/V2I	dual axis,range +/- 5°,Vcc 12...24VDC,output I
G-NSV2-003	NS-15/V2	dual axis,range +/-15°,Vcc 12...24VDC,output V
G-NSV2I-003	NS-15/V2I	dual axis,range +/-15°,Vcc 12...24VDC,output I
G-NSV2-006	NS-45/V2	dual axis,range +/-45°,Vcc 12...24VDC,output V
G-NSV2I-006	NS-45/V2I	dual axis,range +/-45°,Vcc 12...24VDC,output I
Single axis units on request		
G-NSMIS-002	connection	2m cable, one sided straight connector Submin.712-series
G-NSMIS-003	connection	2m cable, one sided angle connector Submin.712-series